

Nick Griggs & Co.

Land Surveyors, 295 Elizabeth Street, North Hobart 7000
 Phone: 6234 5022 Fax: 6231 2412

PLAN OF SUBDIVISION

OWNER: PETER FERGUSSON

LOCATION: 139 SALTWORKS ROAD LITTLE SWANPORT

MUNICIPALITY: GLAMORGAN SPRING BAY

Important Note:

This plan was prepared as a proposed subdivision to accompany a subdivision application to Glamorgan Spring Bay Council and should not be used for any other purpose. The dimensions, areas and total number of lots shown hereon are subject to field survey and also to the requirements of Council and any other authority which may have requirements under any relevant legislation. In particular, no reliance should be for any financial dealings involving the land. This note is an integral part of this plan.

MEASUREMENTS ARE IN METRES AND SUBJECT TO FINAL SURVEY

SCALE: 1:2000

CONTOUR INT: 0.5m

DATE: 20/10/2017

REF: C.T.17693/27

File No: 420906

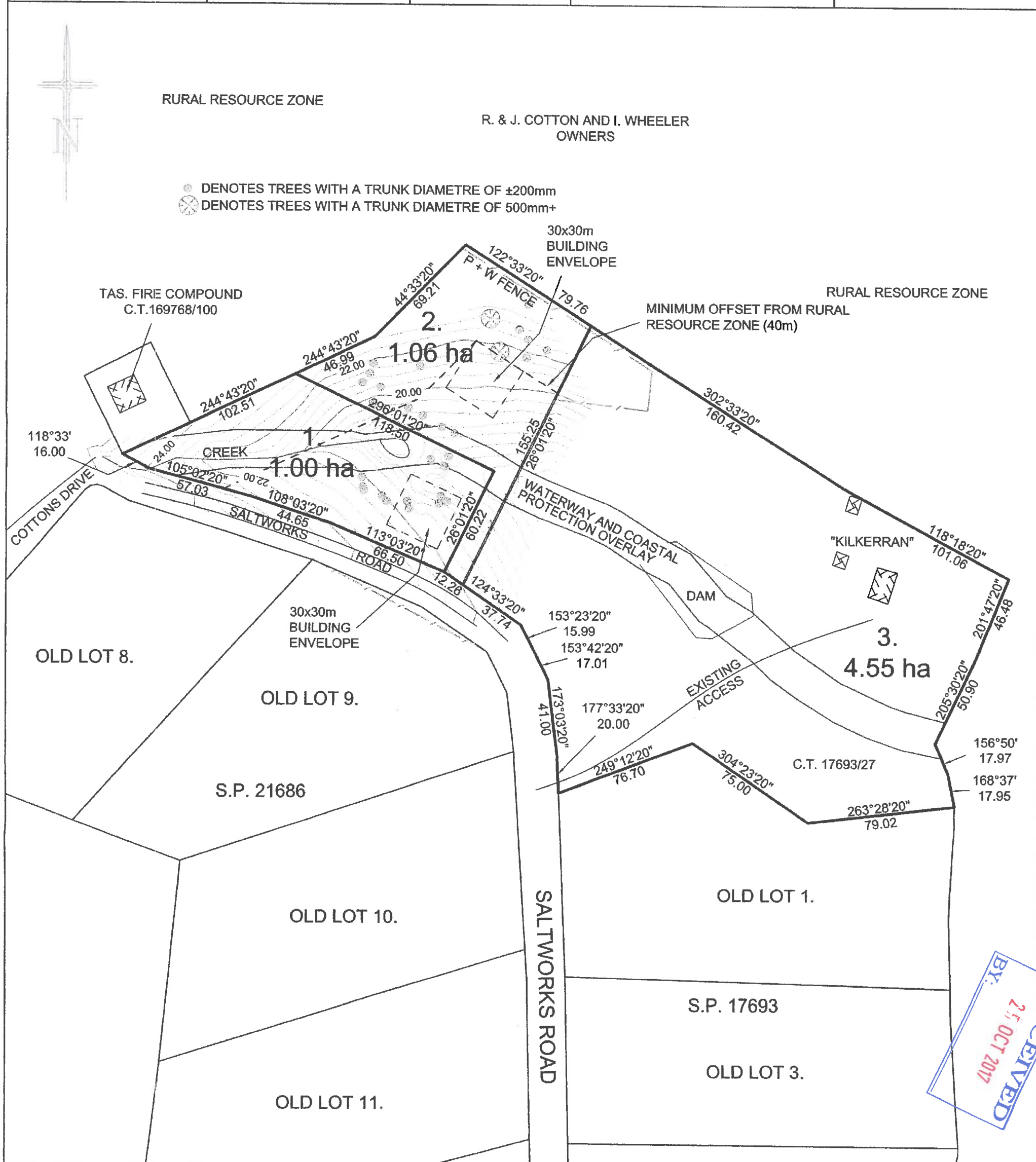

RECEIVED
 BY: 25 OCT 2017

Nick Griggs & Co.

Land Surveyors, 295 Elizabeth Street, North Hobart 7000
Phone: 6234 5022. Fax: 6231 2412

PLAN OF SUBDIVISION

OWNER: PETER FERGUSSON

LOCATION: 139 SALTWORKS ROAD LITTLE SWANPORT

MUNICIPALITY: GLAMORGAN SPRING BAY

Important Note:

This plan was prepared as a proposed subdivision to accompany a subdivision application to Glamorgan Spring Bay Council and should not be used for any other purpose. The dimensions, areas and total number of lots shown hereon are subject to field survey and also to the requirements of Council and any other authority which may have requirements under any relevant legislation. In particular, no reliance should be for any financial dealings involving the land. This note is an integral part of this plan.

MEASUREMENTS ARE IN METRES AND SUBJECT TO FINAL SURVEY

SCALE: 1:1000



CONTOUR INT: 0.5

DATE: 06/09/2017

TITLE REF: C.T.17693/27

File No: 420905

R. & J. COTTON AND I. WHEELER
OWNERS

-  DENOTES TREES WITH A TRUNK DIAMETRE OF ±200mm
-  DENOTES TREES WITH A TRUNK DIAMETRE OF 500mm+



RURAL RESOURCE ZONE

