



76 TRIANGLE MARSH ROAD
 TITLE REFERENCE: 114277/4
 PROPERTY ID: 1619892
 SITE AREA: 17.684ha

01 SITE PLAN
 SCALE 1:2000



Copyright © 2017 Edwards + Simpson Pty Ltd
 This drawing must be used in accordance with all other drawings, specifications, schedules and contract documents. Any discrepancies must be referred to the contract documents. The client is responsible for ensuring that the drawing is used in accordance with the contract documents.

Revisions
 No. Description
 1. Initial design
 2. Final design
 3. Final design
 4. Final design



Project: TRIANGLE MARSH SHED
 Prepared by: HARRY AND TONI-MARIE HRYCOWSYN
 Checked by: HARRY AND TONI-MARIE HRYCOWSYN
 Approved by: HARRY AND TONI-MARIE HRYCOWSYN
 Scale: 1:2000 @ 0.3

Drawing No: SITE PLAN
 Date issued: 20/07/16
 Checked: [Signature]
 Approved: [Signature]
 Scale: 1:2000 @ 0.3

Edwards + Simpson Pty Ltd
 40/32-40/38 Sturt Street, Adelaide SA 5001
 A Level 1, 69-71 Sturt Street, Adelaide SA 5001
 E: edwardsandsimpson.com.au T: 08 5321 1881
 F: 08 5321 1881
 Director: HARRY AND TONI-MARIE HRYCOWSYN
 A1
 APPROVAL

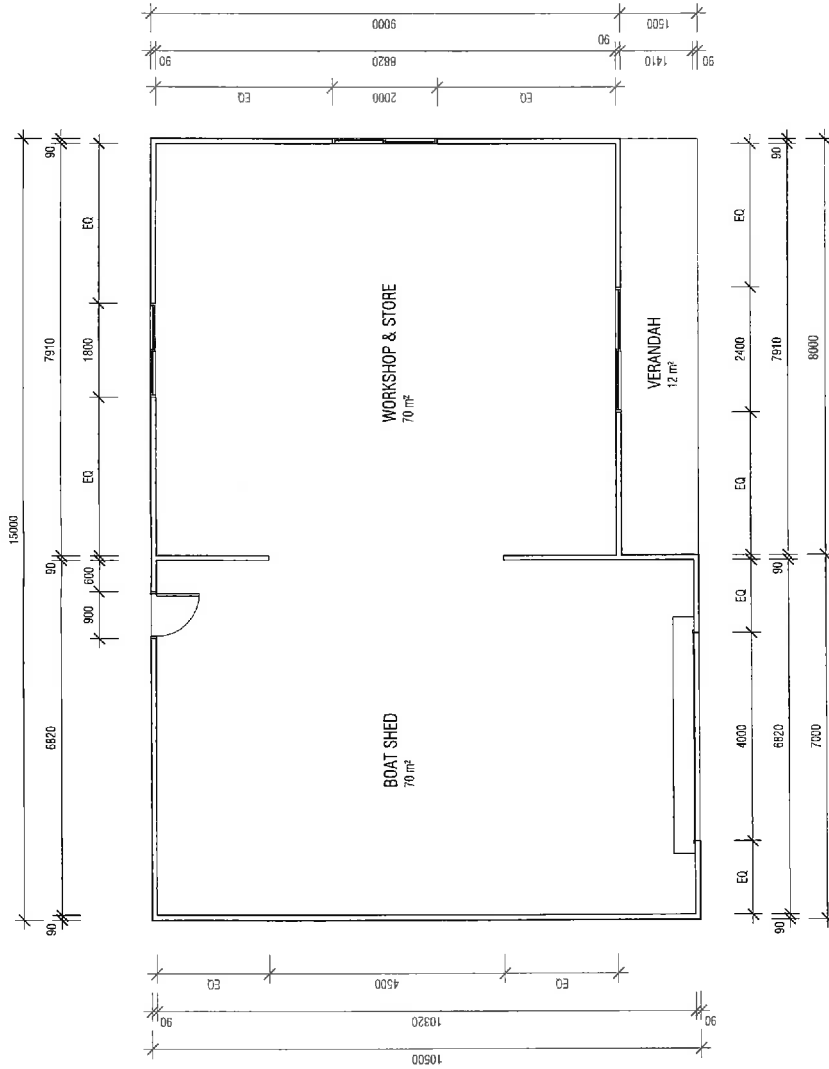

01 SETOUT PLAN
SCALE: 1:100

	<p>Copyright © 2017 Edwards and Simpson Pty Ltd No part of this drawing may be reproduced, stored in a retrieval system, or transmitted in any form or by any means, electronic, mechanical, photocopying, recording, or otherwise, without the prior written permission of Edwards and Simpson. In any event, all rights are reserved.</p>	<p>Drawings Date: 26/03/14 Project: 1320214 - 6748700 - CLIENT REVIEW</p>	<p>Project: TRIANGLE MARSH SHED 26 TRIANGLE MARSH ROAD HARRY AND TON-MARE HRYCYSZYN 75 TRIANGLE MARSH ROAD PORTLAND TAS 7170</p>	<p>Drawings SETOUT PLAN Date checked: 1/02/18 Scale: 1:100 @ A1</p>	<p>Edwards + Simpson Pty Ltd A Level 10/20 St John Street Launceston TAS 7250 Australia Phone: +61 8 3333 3333 Fax: +61 8 3333 3333 Email: info@edwardsandsimpson.com.au Drawing number: A231 Revision: A1</p>
	<p>APPROVAL</p>	<p>APPROVAL</p>	<p>APPROVAL</p>	<p>APPROVAL</p>	

